

nita[®]

NITA SC SPEED CONTROL RETRACTABLE HOSE REELS SYSTEMS



STANDARD RETRACTABLE HOSE REEL

Retraction Speed
2 mps

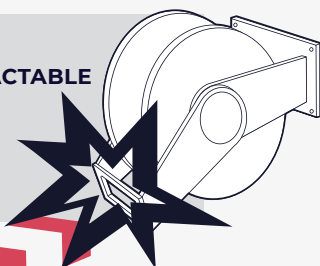

NITA SC SPEED CONTROL HOSE REEL SYSTEM

Retraction Speed
0.7 mps



NITA SC

SPEED CONTROL SYSTEM



OPERATOR SAFETY

The Nita SC Speed Control brake reduces the reel rewinding speed in the event of accidental hose release.

For this reason, it is possible for the operators to work in safer conditions avoiding injury to operators and damage to the hose, hose reel and accessories.



SLOWER RETRACT SPEED

With the NITA SC Speed Control System, retract speed is reduced to a safer 0.7 meters per second, compared to the industry average reel at 2 meters per second.



UNIQUE BRAKE LOCKING FEATURE

The Nita SC Brakes ratchet is designed to prevent accidental release by pressure shocks. This unique feature stops the pawl from suddenly disengaging the spring and causing the hose to retract without warning.



Blue foodgrade plastic hose roller guide,
suitable for food industry



AVAILABLE FOR NITA SC REELS

The Speed Control Unit can be retrofitted to any of the Nita SC Hose Reels.



NITA SC

SPEED CONTROL SYSTEM



The unique Nita Speed Control system is designed to control the hose rewinding speed for the Nita SC series 2214, 2215 and 2216 (including the swivel versions).

The Nita Speed Control system acts as a safety brake in the event of accidental hose release by the operator. The hose reel will retract slowly reducing risk of harm to operators and damage to equipment.

Features include

SLOWED REWINDING

For safer working conditions

TECHNO POLYMER COVER

High resistance cover to withstand impacts

WATER RESISTANCE

Entirely Waterproof with IP65 protection degree

STAINLESS STEEL

The stainless steel hose reel connection pin and screws are suitable for corrosive working environments.



OVERALL DIMENSIONS (MM)

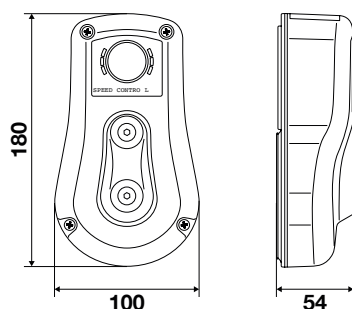

HELPFUL HINT

The "Speed Control" components are designed to last for the life time of the hose reel providing they are lubricated according to the instruction manual

QJS (UK) Ltd suggests to lubricate the internal gears once a year as indicated in the instruction manual.

Shockproof Cover

In black high resistance techno-polymer

Fixing Screws in stainless steel

Nita SC Braking System

Molded Seals

To guarantee the IP65 protection degree

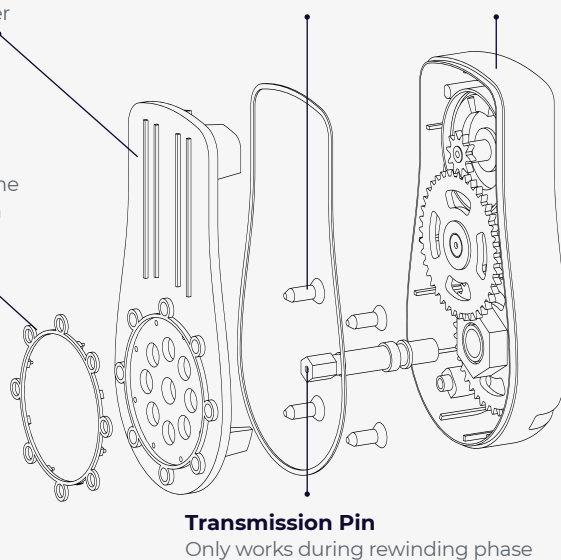

NITA SC

STAINLESS STEEL HOSE REELS

The Nita SC Retractable Hose Reels are engineered to withstand the rigours of the food industry.

HOSE SIZE

The Nita SC Hose Reels are suitable for 3/8", 1/2" and 3/4" hose

HOSE LENGTH

Hose lengths up to 15m, 25m or 30m available

SWIVEL BRACKETS

Available for all reel size options

HOSE ROLLER GUIDE

Blue foodgrade plastic, suitable for food industry

SEALS

All Nita SC Hose Reels are supplied with Viton Seals

MAX PRESSURE

Up to 150 bar (see technical specification sheet for full details)

STAINLESS STEEL

Constructed in AISI204 Stainless Steel



NITA SC

WARRANTY



QJS (UK) Ltd provides each product with the communication of particular instructions for the installation, use and maintenance requirements and the need to carry out possible checks on the product. Incorrect installation, use or maintenance of the product shall void the warranty.

The Nita SC product must be returned to QJS (UK) Ltd for checking and acceptance. All the technical information and data provided are not binding and can be changed without prior notice for the purpose of improving the quality of the products.

All Nita SC products manufactured by QJS (UK) Ltd are guaranteed for a period of 5 (five) years.

The 5 (five) year guarantee does not apply to components which are subject to normal wear and tear (such as gaskets, membranes, O-rings, hoses, etc), which are guaranteed for 1(one) year.